

**A Revolutionary Innovation in Chemical Pump Technology...**

## **The Liquiflo POLY-GUARD™**

Polymer-Lined Stainless Steel Gear Pump

**...The Ultimate Solution for Pumping Corrosive Chemicals**



**Combines the chemical resistance of Fluoro-Polymers  
with the strength of Stainless Steel**

**Liquiflo®**  
Chemical Processing Pumps

**Poly-Guard™**

# Poly-Guard™ SERIES

## POLYMER-LINED STAINLESS STEEL GEAR PUMP



### Description: THE TOUGHEST COMBINATION...

Liquiflo has long recognized the need for a Plastic Rotary Positive Displacement Pump for the chemical industry. While engineered plastics offered unsurpassed chemical resistance to virtually any fluid, they severely lacked the mechanical strength, integrity and safety of high-alloy metals. Therefore, the challenge was to use a combination of metal and plastic to produce a highly corrosion resistant pump that was safe to use in industrial applications. We chose a Fluoro-Polymer for its superior chemical resistance, and Stainless Steel for its strength and corrosion resistance (giving the pump one more layer of protection). Liquiflo perfected a specialized molding and machining technique for mechanically bonding, stabilizing and machining the plastic to the precise tolerances required to make a positive displacement pump.

The ultimate outcome was the Poly-Guard™, which combines the chemical resistance of a Fluoro-Polymer with the strength of Stainless Steel.

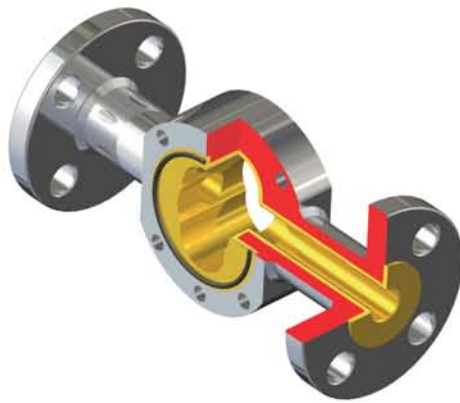

### Typical Uses & Applications

The **Poly-Guard™** is an excellent choice for inorganic acids, bases and salts. The Poly-Guard™, with its tough Stainless Steel exterior and chemically resistant Fluoro-Polymer interior, offers the ultimate solution for your most difficult chemical applications. These pumps are durable, safe and corrosion resistant, and unlike fiber-reinforced plastic pumps, they can also be used in high purity services where contamination from process system components must be avoided.

### Typical Chemicals

Hydrochloric Acid  
 Ferric Chloride  
 Sulfuric Acid  
 Hydrofluoric Acid  
 Sodium Hypochlorite  
 Nitric Acid  
 Sodium Hydroxide  
 Chromic Acid  
 Fluorosilicic Acid  
 Hydrogen Bromide  
 Bromine

### Markets

Chemical  
 Water Treatment  
 Pharmaceutical  
 Pulp & Paper  
 Electronics  
 Food & Beverage  
 High Purity Service  
 ...etc.

### Metering

Gear pumps, due to their nearly **pulseless flow**, are preferred in many metering applications. When used with a VFD in a PID-controlled feedback loop, the pump can deliver exceptionally accurate flow. The input signal can be based on many different parameters – pH and flow rate being two of the most common.

## Advantages

- ▶ The Poly-Guard™ offers both internal and external protection against corrosive fluids and harsh environments
- ▶ Strong Stainless Steel body handles pipe stresses and typical treatments found in industrial environments
- ▶ Fluoro-Polymer-lined for ultimate protection against any corrosive liquids, such as Acids, Caustics, Inorganic Salts and others
- ▶ A variety of non-metallic materials for internal components such as PEEK, Kynar (PVDF) and Silicon Carbide, were chosen for exceptional wear resistance and chemical compatibility, allowing pump to be optimized for the intended service
- ▶ Ideal for high purity services (All wetted parts are non-metallic)
- ▶ Sealless Mag-Drive configuration prevents leakage
- ▶ Rotary Gear Pump design deliverer a smooth, pulseless flow which is desirable for both metering and transfer applications
- ▶ Close-Coupled configuration simplifies installation and maintains perfect alignment of pump and motor
- ▶ Product is extremely simple in design and easy to maintain and repair
- ▶ Available in 7 sizes to match your flow requirements up to 15 GPM (57 LPM)

# Liquiflo **POLY-GUARD™** SERIES Polymer-Lined The **Ultimate Solution** for Pumping **Corrosive Chemicals**

## THE TOUGHEST EXTERIOR

An extremely durable 300-Series Stainless Steel body clearly sets the Poly-Guard™ apart from all other plastic pumps. Its strong and chemically resistant body truly makes the Poly-Guard™ the perfect match for harsh industrial environments.

STAINLESS  
STEEL FLANGES

STAINLESS  
STEEL BODY

STAINLESS STEEL  
CONTAINMENT CAN

## THE MOST CHEMICALLY RESISTANT INTERIOR

**Fluoro-Polymer Plastic  
Lining** resists the most  
corrosive chemicals

All inside surfaces contain a molded layer of Fluoro-Polymer – the most chemically resistant of all plastics. This layer (shown in gold) is molded, mechanically fastened and chemically bonded to the Stainless Steel outer casing; then precision-machined to close tolerances.

This combination of the toughest exterior and the most chemically resistant interior is the ultimate solution for your most difficult pumping applications.

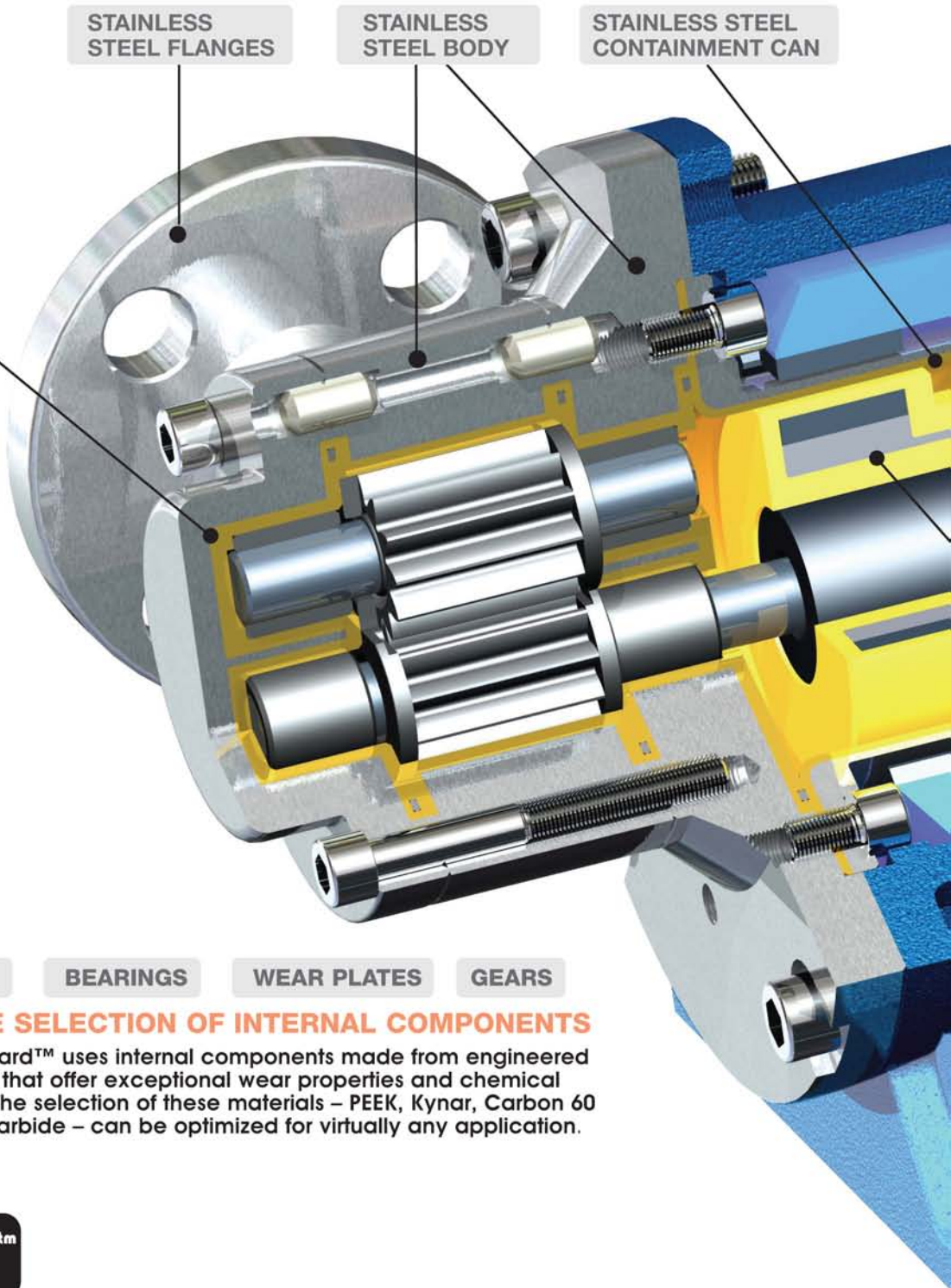

SHAFTS

BEARINGS

WEAR PLATES

GEARS

## FLEXIBLE SELECTION OF INTERNAL COMPONENTS

The Poly-Guard™ uses internal components made from engineered materials that offer exceptional wear properties and chemical resistance. The selection of these materials – PEEK, Kynar, Carbon 60 or Silicon Carbide – can be optimized for virtually any application.

**Poly-Guard™**

# Stainless Steel Gear Pump

Combines the chemical resistance of Fluoro-Polymer with the strength of Stainless Steel

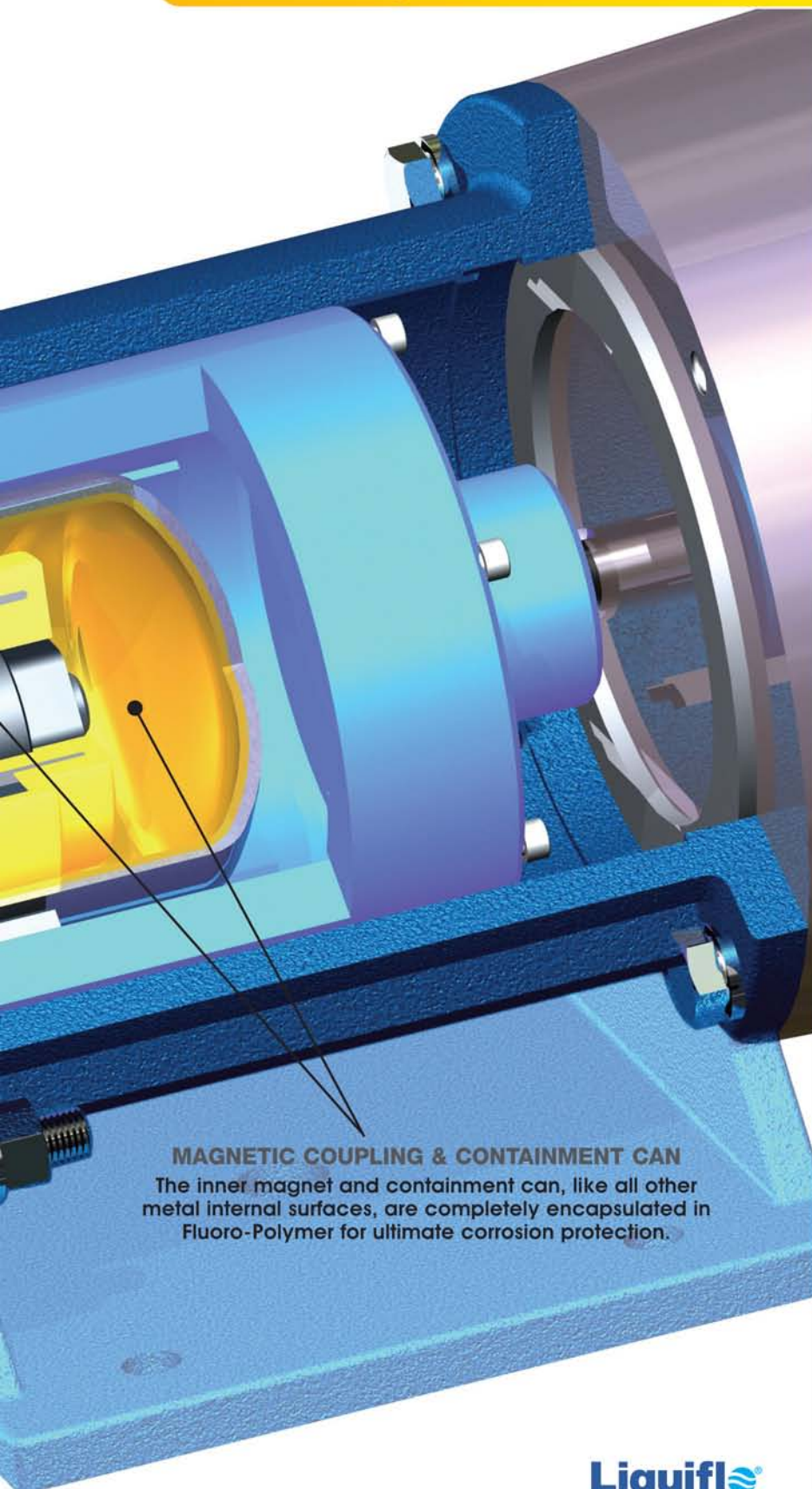

## MAGNETIC COUPLING & CONTAINMENT CAN

The inner magnet and containment can, like all other metal internal surfaces, are completely encapsulated in Fluoro-Polymer for ultimate corrosion protection.

## THE FLUORO-POLYMER LINER

The interior walls of the Stainless Steel housing are encased with perfluoroalkoxy plastic, which is a type of Fluoro-Polymer commonly known by its acronym, PFA. PFA was chosen because it's the most chemically resistant of all moldable plastics. In the Poly-Guard™ design, the PFA is supported by the Stainless Steel housing; therefore, no additional reinforcements (such as fiber fillers which are necessary to strengthen an all plastic pump) are needed. In fiber reinforced plastic pumps, these fillers can significantly reduce the chemical resistance of the plastic and potentially allow wicking of the chemical along the fiber matrix.

## INTERNAL COMPONENTS

The Poly-Guard™ pump is offered with a wide selection of materials for its internal components. With Liquiflo's many years of experience in pumping extremely difficult chemicals, we can maximize the performance and reliability of the Poly-Guard™ for virtually any application. In several applications, by optimizing component selection, Liquiflo has exceeded 40,000 hours of MTBR (mean time between replacement).

**SHAFTS** Self-Sintered Silicon Carbide (SiC) for extreme wear resistance and chemical resistance.

**BEARINGS** Silicon Carbide Bearings for extreme life and wear resistance, or Carbon 60 Bearings for flexibility and dry-running capability.

**GEARS** Choice of PEEK or Kynar Gears to optimize performance for chemical applications.



## CONTAINMENT CAN

The standard containment can material is PTFE-Lined Stainless Steel, which provides both extreme chemical resistance and high-pressure capability.

## REPAIR KITS

These pumps are extremely simple to repair and maintain. Either individual parts or complete repair kits that contain all internal components are available to economically rebuild the pump to like-new condition.



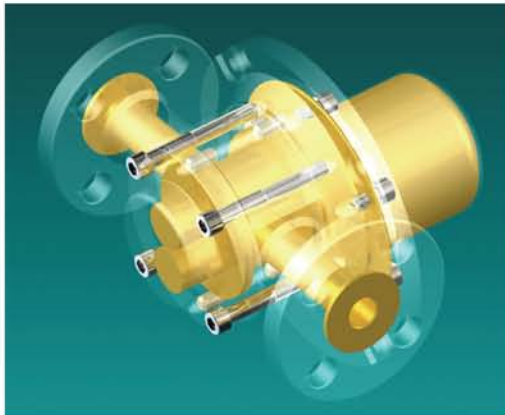
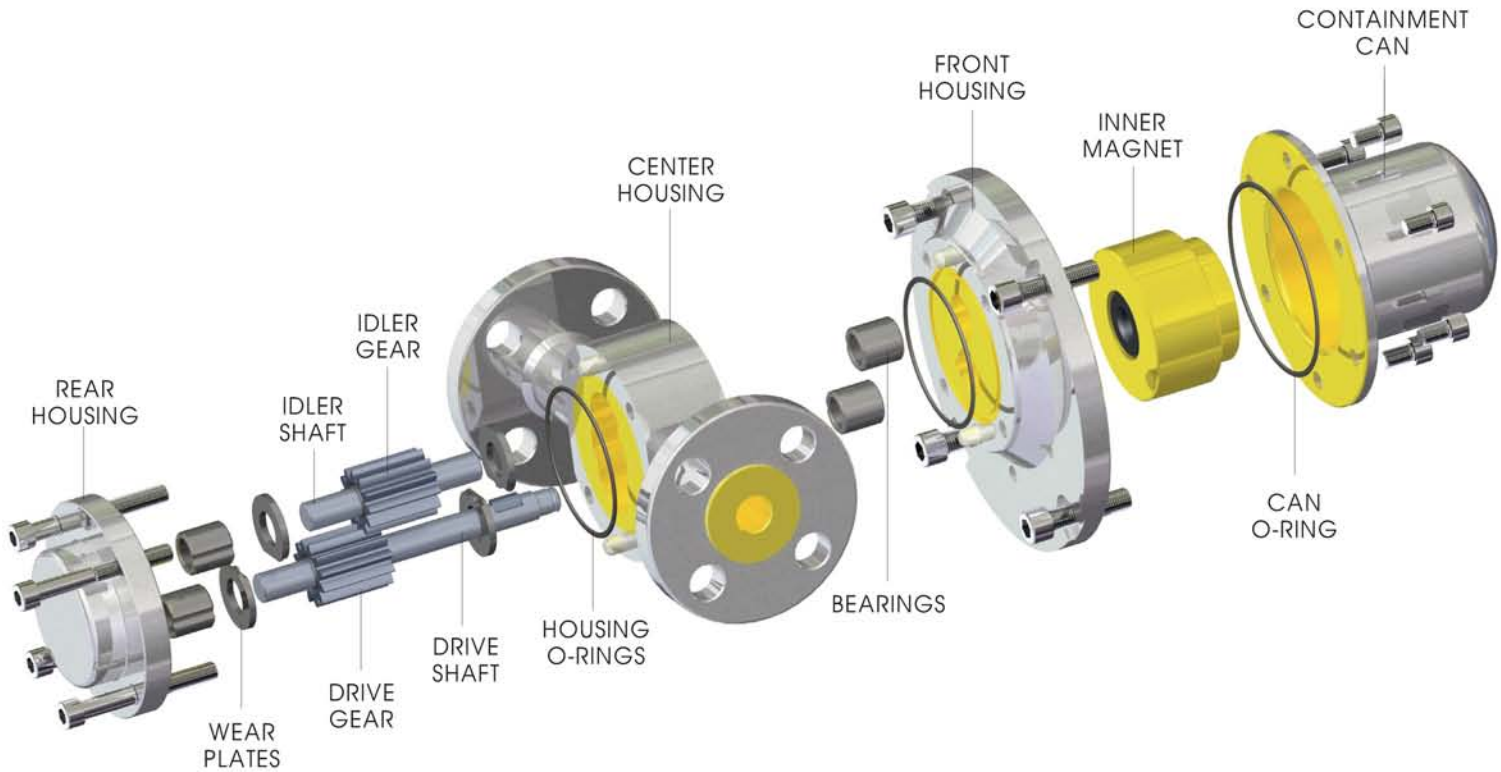

The **Poly-Guard™** Series pumps offer a durably constructed outer Stainless Steel body with a heavily layered Fluoro-Polymer (PFA) internal lining. This highly chemically resistant PFA lining is mechanically attached and bonded to the internal stainless steel surfaces using a specialized molding process, effectively isolating the fluid being pumped from any metal surfaces. Fluoro-Polymers exhibit the highest corrosion resistance of any plastics. This combination of stainless steel on the outside and Fluoro-Polymer on the inside gives the Poly-Guard™ the full strength and integrity of a metal pump with the ultimate corrosion resistance of a Fluoro-Polymer.

(Polymer lining is shown in gold)

## Case History

A water supply authority was required to fluoridate the water system for a large metropolitan area. The method chosen was metered injection of concentrated Hydrofluorosilicic Acid into the water supply. Any process Interruption or fluid leakage would be unacceptable. Originally, diaphragm metering pumps were specified; however, they were found to be unsatisfactory due to leakage as a result of diaphragm failure. They then chose a gear pump with an Alloy-C body; however, the Alloy-C was severely attacked by the acid, resulting in fluid leakage within a month. Liquiflo was then approached to help them find a solution. Liquiflo recognized that an all metal pump was not acceptable from a corrosion standpoint. It was also known that glass and carbon were incompatible with this highly corrosive acid. This eliminated the option of using an all plastic pump that used carbon or glass fiber reinforcement. The solution was the Poly-Guard™ pump with PFA lining, Stainless Steel body, unfilled PVDF gears, and Silicon Carbide wear plates, bearings and shafts. These pumps have now been in service in excess of 18 months with zero down time due to fluid leakage or degraded performance.

### MODELS

#### P1-P4



### MODELS

#### P5-P7



### GENERAL SPECIFICATIONS

SPECIFICATION	Units	P1	P2	P3	P4	P5	P6	P7	
Port Size & Type*	ANSI 150#	in	3/4	3/4	3/4	3/4	1 1/2	1 1/2	1 1/2
	DIN PN16	mm	20	20	20	20	40	40	40
Theoretical Displacement <sup>1</sup>	gal/rev	.000828	.00138	.00193	.00289	.00491	.00675	.00859	
	L/rev	.00313	.00522	.00731	.01094	.01858	.02555	.03251	
Max Speed	RPM	1750	1750	1750	1750	1750	1750	1750	
Max Flow Rate <sup>1</sup>	GPM	<b>1.4</b>	<b>2.4</b>	<b>3.4</b>	<b>5.0</b>	<b>8.6</b>	<b>11.8</b>	<b>15.0</b>	
	LPM	5.5	9.1	12.8	19.1	32.5	44.7	56.9	
Max Differential Pressure	PSI	100	100	100	100	100	100	100	
	bar	7	7	7	7	7	7	7	
Max Allowable Pressure <sup>2</sup>	PSIG	275	275	275	275	275	275	275	
	barg	19	19	19	19	19	19	19	
Max Temperature	°F	200	200	200	200	200	200	200	
	°C	93	93	93	93	93	93	93	
NPSHR @ Max Speed	ft	2	2	2	3	5.2	5.2	4	
	m	0.6	0.6	0.6	0.9	1.6	1.6	1.2	
Suction Lift (Dry)	ft	1.5	2	4	6	6	7	7	
	m	0.45	0.6	1.2	1.8	1.8	2.1	2.1	
Weight, less motor (approx.)	lbs	42	42	42	42	63	63	63	
	kg	19	19	19	19	29	29	29	

\* Raised Face (RF) Flanges

<sup>1</sup> Based on Maximum Speed and zero Differential Pressure.

<sup>2</sup> Based on pressure rating of Flanges at ambient temperature.

### MATERIALS AVAILABLE

BODY	GEARS	WEAR PLATES	BEARINGS	SHAFTS
SS-PFA Plastic-Lined	PEEK <sup>1</sup> Kynar <sup>2</sup>	Silicon Carbide <sup>3</sup> Carbon-60	Silicon Carbide <sup>3</sup> Carbon-60	Silicon Carbide <sup>3</sup>

<sup>1</sup> Bearing Grade PEEK

<sup>2</sup> FDA Grade PVDF

<sup>3</sup> Self-sintered SiC

## POLYMER-LINED STAINLESS STEEL GEAR PUMP

MODEL **P1**



**MAG-DRIVE, CLOSE-COUPLED**

Port Size & Type	ANSI	3/4" 150# RF Flanges
	DIN	20 mm PN16 RF Flanges
Theoretical Displacement <sup>1</sup>		.000828 gal/rev (.00313 L/rev)
Max Speed		1750 RPM
Max Flow Rate <sup>1</sup>		<b>1.4 GPM (5.5 LPM)</b>
Max Differential Pressure		100 PSI (7 bar)
Max Allowable Pressure <sup>2</sup>		275 PSIG (19 barg)
Max Temperature		200°F (93°C)
NPSHR @ Max Speed		2 ft (0.6 m)
Suction Lift (Dry)		1.5 ft (0.45 m)
Gear Type		Spur, External
Bearing Type		Sleeve /Journal
Motor Frame Sizes	NEMA	56C, 143TC, 145TC
	IEC	71, 80, 90 - B5 Flange
Weight, less motor (approx.)		42 lbs (19 kg)

<sup>1</sup> Based on Maximum Speed and zero Differential Pressure.

<sup>2</sup> Based on pressure rating of Flanges at ambient temperature.

### PERFORMANCE CURVES

**1 CPS Fluid (Water)**

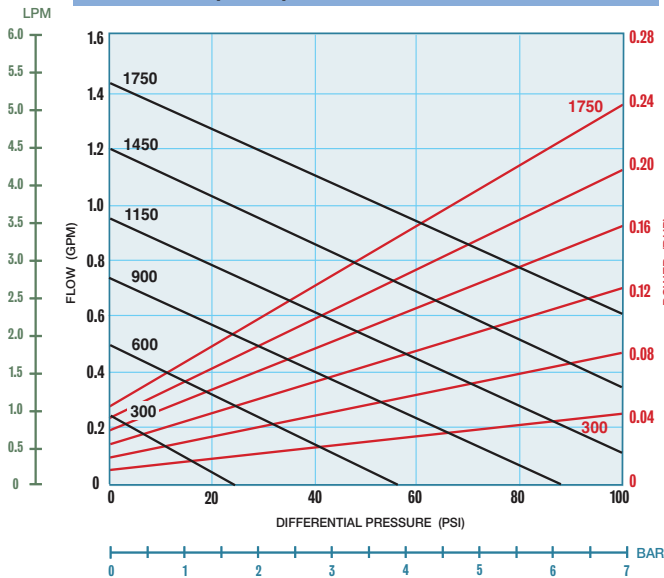

**100 CPS Fluid (Oil)**

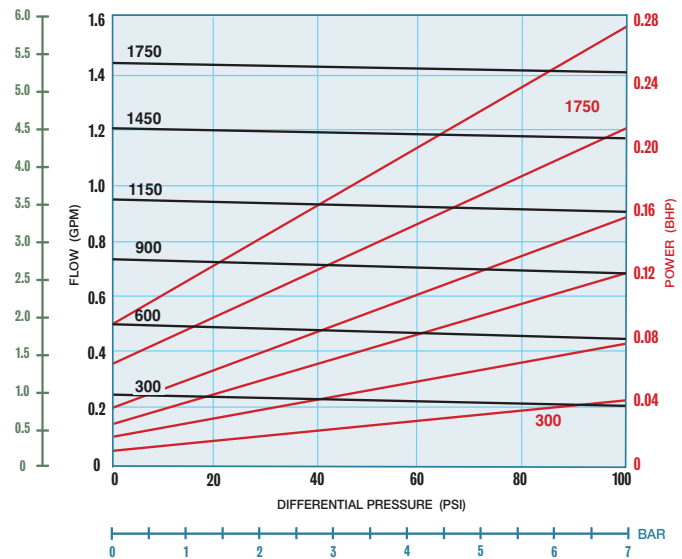

### P1: Mag-Drive, Close-Coupled

Dimensional Data: inches [mm]

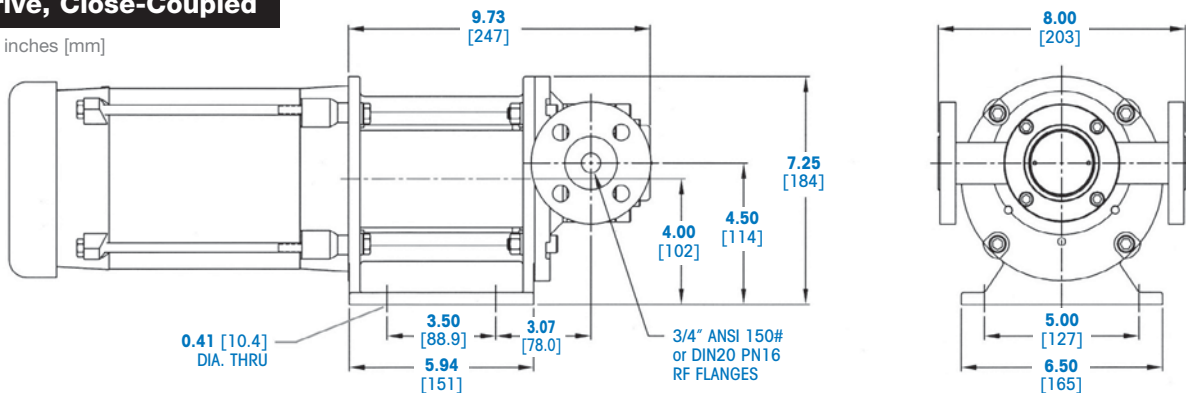

## POLYMER-LINED STAINLESS STEEL GEAR PUMP

MODEL **P2**



**MAG-DRIVE, CLOSE-COUPLED**

Port Size & Type	ANSI	3/4" 150# RF Flanges
	DIN	20 mm PN16 RF Flanges
Theoretical Displacement <sup>1</sup>		.00138 gal/rev (.00522 L/rev)
Max Speed		1750 RPM
Max Flow Rate <sup>1</sup>		<b>2.4 GPM (9.1 LPM)</b>
Max Differential Pressure		100 PSI (7 bar)
Max Allowable Pressure <sup>2</sup>		275 PSIG (19 barg)
Max Temperature		200°F (93°C)
NPSHR @ Max Speed		2 ft (0.6 m)
Suction Lift (Dry)		2 ft (0.6 m)
Gear Type		Spur, External
Bearing Type		Sleeve /Journal
Motor Frame Sizes	NEMA	56C, 143TC, 145TC
	IEC	71, 80, 90 – B5 Flange
Weight, less motor (approx.)		42 lbs (19 kg)

1 Based on Maximum Speed and zero Differential Pressure.

2 Based on pressure rating of Flanges at ambient temperature.

### PERFORMANCE CURVES

**1 CPS Fluid (Water)**

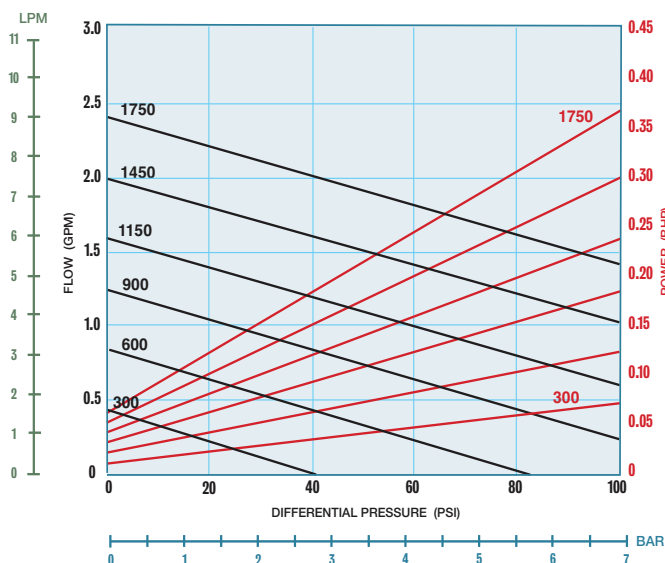

**100 CPS Fluid (Oil)**

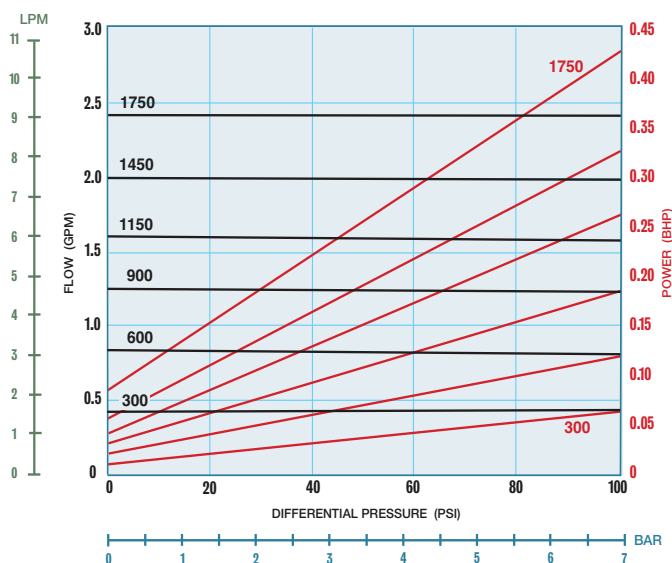

### P2: Mag-Drive, Close-Coupled

Dimensional Data: inches [mm]

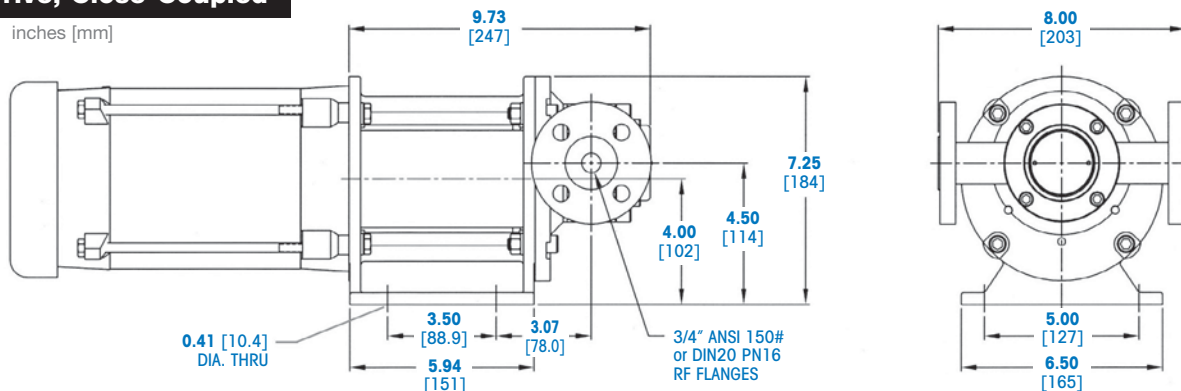



## POLYMER-LINED STAINLESS STEEL GEAR PUMP

MODEL **P3**



**MAG-DRIVE, CLOSE-COUPLED**

Port Size & Type	ANSI	3/4" 150# RF Flanges
	DIN	20 mm PN16 RF Flanges
Theoretical Displacement <sup>1</sup>		.00193 gal/rev (.00731 L/rev)
Max Speed		1750 RPM
Max Flow Rate <sup>1</sup>		<b>3.4 GPM (12.8 LPM)</b>
Max Differential Pressure		100 PSI (7 bar)
Max Allowable Pressure <sup>2</sup>		275 PSIG (19 barg)
Max Temperature		200°F (93°C)
NPSHR @ Max Speed		2 ft (0.6 m)
Suction Lift (Dry)		4 ft (1.2 m)
Gear Type		Spur, External
Bearing Type		Sleeve /Journal
Motor Frame Sizes	NEMA	56C, 143TC, 145TC
	IEC	71, 80, 90 – B5 Flange
Weight, less motor (approx.)		42 lbs (19 kg)

1 Based on Maximum Speed and zero Differential Pressure.  
 2 Based on pressure rating of Flanges at ambient temperature.

### PERFORMANCE CURVES

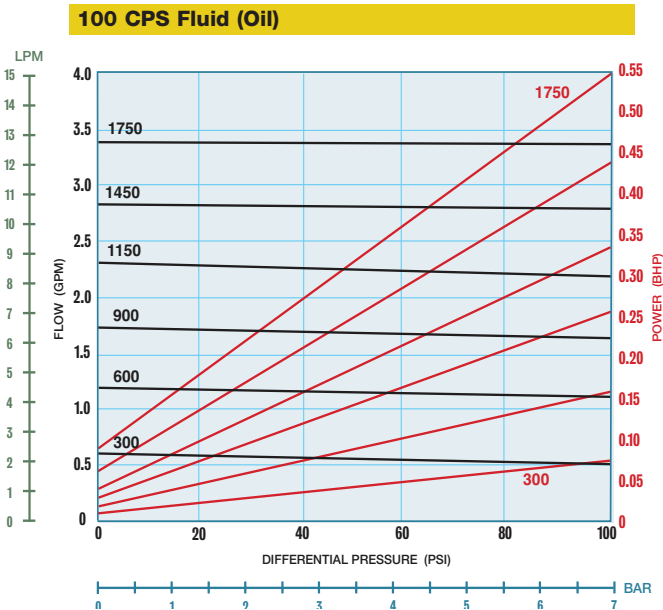
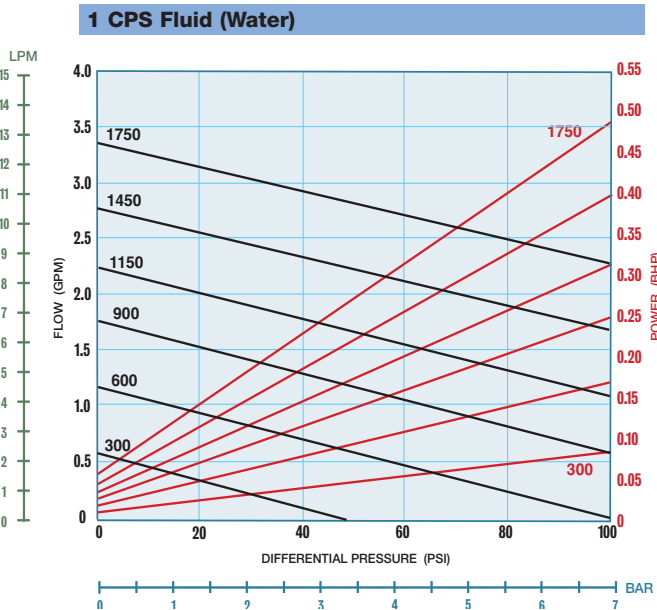

### P3: Mag-Drive, Close-Coupled

Dimensional Data: inches [mm]

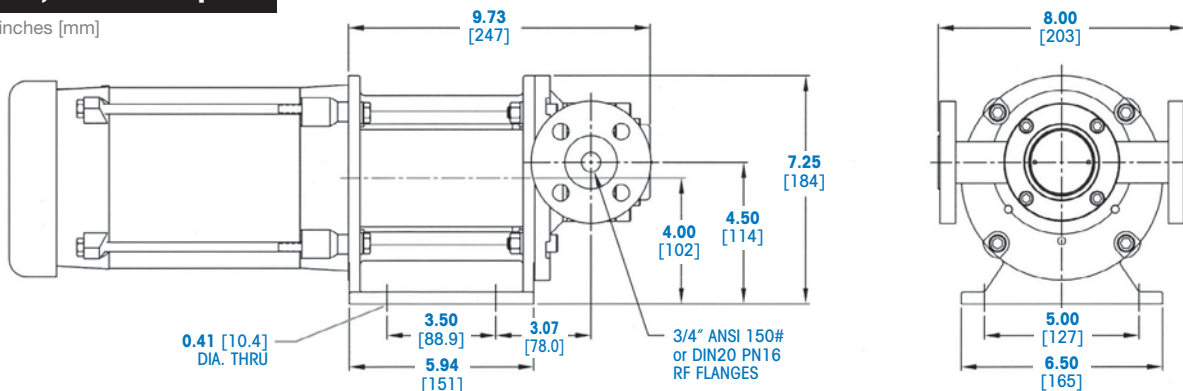

## POLYMER-LINED STAINLESS STEEL GEAR PUMP

MODEL **P4**



**MAG-DRIVE, CLOSE-COUPLED**

Port Size & Type	ANSI	3/4" 150# RF Flanges
	DIN	20 mm PN16 RF Flanges
Theoretical Displacement <sup>1</sup>		.00289 gal/rev (.01094 L/rev)
Max Speed		1750 RPM
Max Flow Rate <sup>1</sup>		<b>5.0 GPM (19.1 LPM)</b>
Max Differential Pressure		100 PSI (7 bar)
Max Allowable Pressure <sup>2</sup>		275 PSIG (19 barg)
Max Temperature		200°F (93°C)
NPSHR @ Max Speed		3 ft (0.9 m)
Suction Lift (Dry)		6 ft (1.8 m)
Gear Type		Spur, External
Bearing Type		Sleeve /Journal
Motor Frame Sizes	NEMA	56C, 143TC, 145TC
	IEC	71, 80, 90 – B5 Flange
Weight, less motor (approx.)		42 lbs (19 kg)

1 Based on Maximum Speed and zero Differential Pressure.

2 Based on pressure rating of Flanges at ambient temperature.

### PERFORMANCE CURVES

**1 CPS Fluid (Water)**

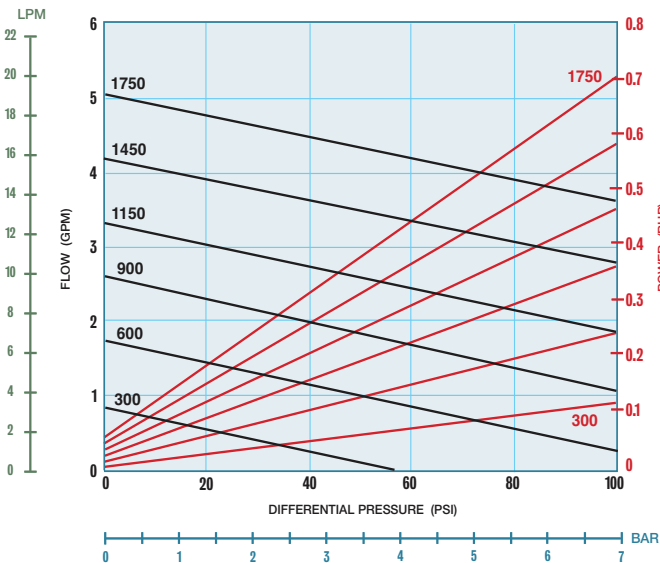

**100 CPS Fluid (Oil)**

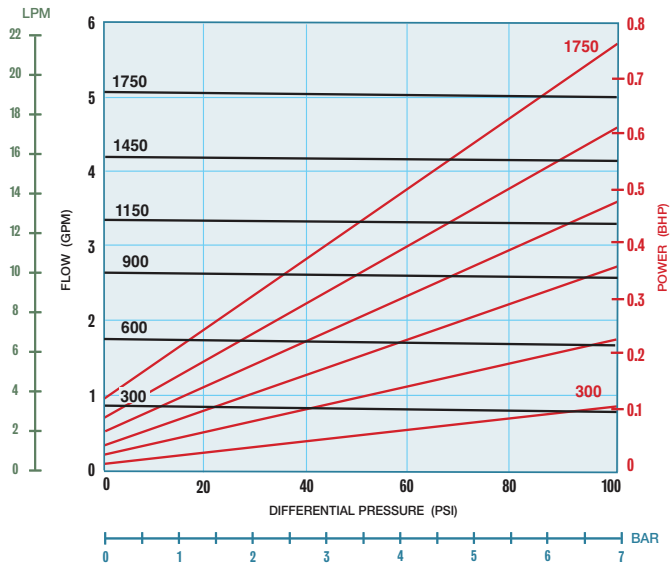

### P4: Mag-Drive, Close-Coupled

Dimensional Data: inches [mm]

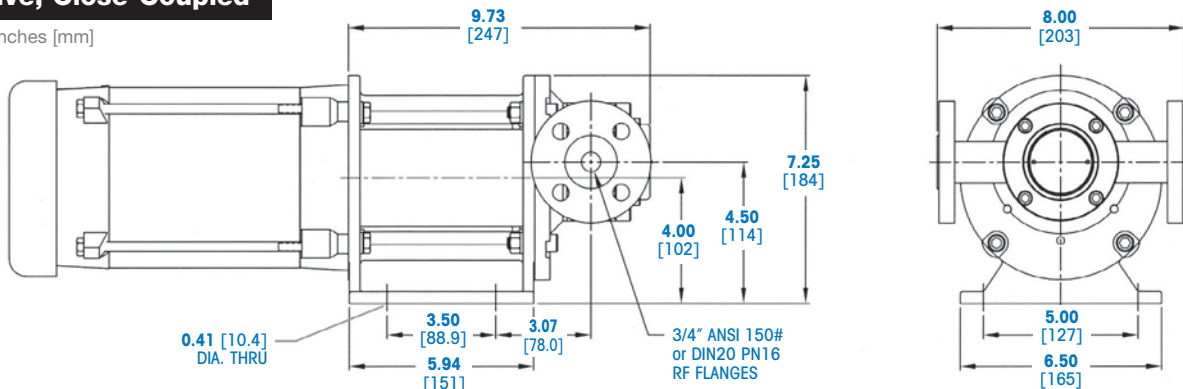

## POLYMER-LINED STAINLESS STEEL GEAR PUMP

MODEL **P5**



**MAG-DRIVE, CLOSE-COUPLED**

Port Size & Type	ANSI	1 1/2" 150# RF Flanges
	DIN	40 mm PN16 RF Flanges
Theoretical Displacement <sup>1</sup>		.00491 gal/rev (.01858 L/rev)
Max Speed		1750 RPM
Max Flow Rate <sup>1</sup>		<b>8.6 GPM (32.5 LPM)</b>
Max Differential Pressure		100 PSI (7 bar)
Max Allowable Pressure <sup>2</sup>		275 PSIG (19 barg)
Max Temperature		200°F (93°C)
NPSHR @ Max Speed		5.2 ft (1.6 m)
Suction Lift (Dry)		6 ft (1.8 m)
Gear Type		Spur, External
Bearing Type		Sleeve /Journal
Motor Frame Sizes	NEMA	56C, 143TC, 145TC, 182TC, 184TC
	IEC	71, 80, 90, 100, 112 - B5 Flange
Weight, less motor (approx.)		63 lbs (29 kg)

<sup>1</sup> Based on Maximum Speed and zero Differential Pressure.

<sup>2</sup> Based on pressure rating of Flanges at ambient temperature.

### PERFORMANCE CURVES

**1 CPS Fluid (Water)**

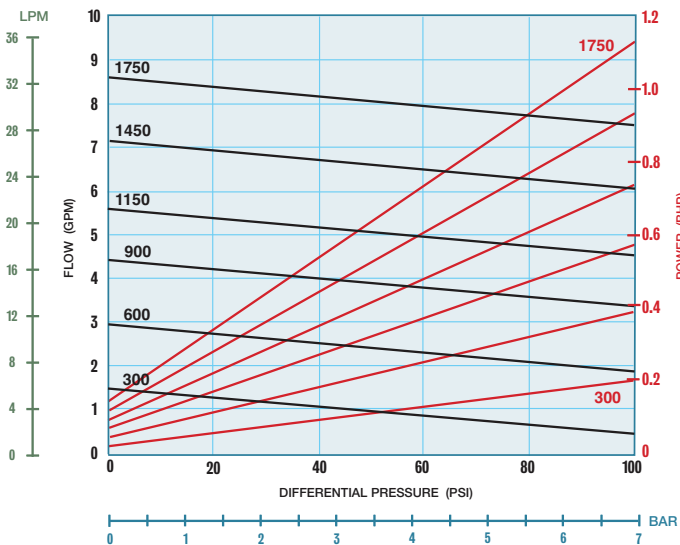

**100 CPS Fluid (Oil)**

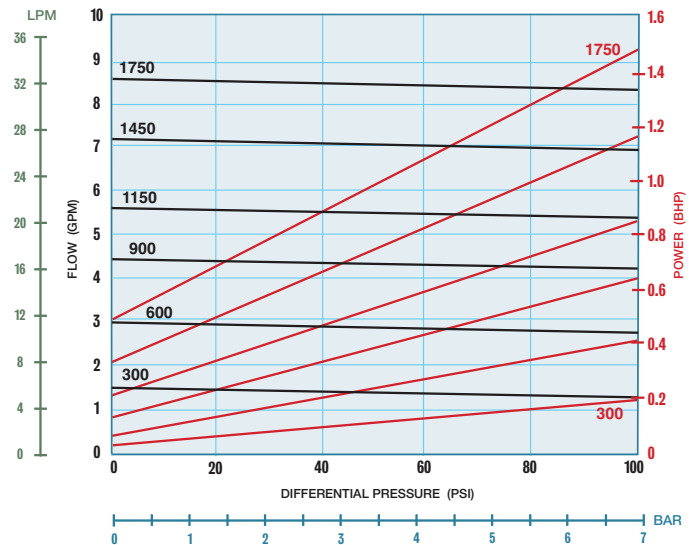

### P5: Mag-Drive, Close-Coupled

Dimensional Data: inches [mm]

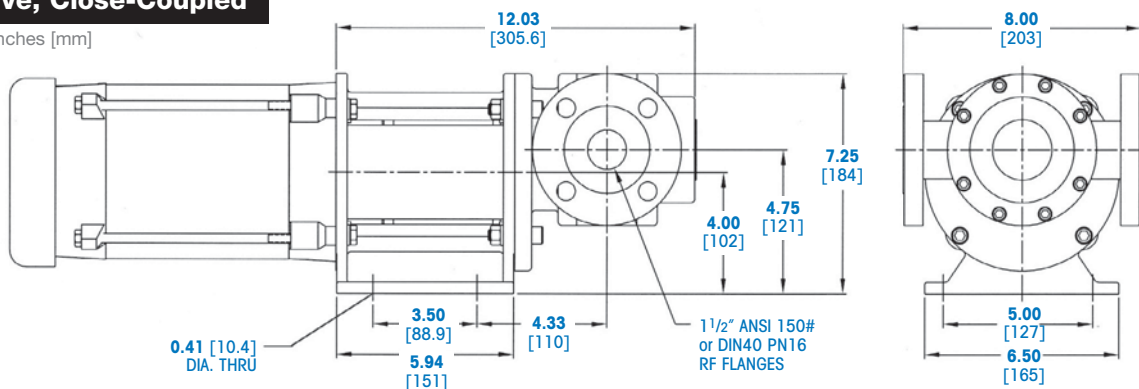

## POLYMER-LINED STAINLESS STEEL GEAR PUMP

MODEL **P6**



**MAG-DRIVE, CLOSE-COUPLED**

Port Size & Type	ANSI	1 1/2" 150# RF Flanges
	DIN	40 mm PN16 RF Flanges
Theoretical Displacement <sup>1</sup>		.00675 gal/rev (.02555 L/rev)
Max Speed		1750 RPM
Max Flow Rate <sup>1</sup>		<b>11.8 GPM (44.7 LPM)</b>
Max Differential Pressure		100 PSI (7 bar)
Max Allowable Pressure <sup>2</sup>		275 PSIG (19 barg)
Max Temperature		200°F (93°C)
NPSHR @ Max Speed		5.2 ft (1.6 m)
Suction Lift (Dry)		7 ft (2.1 m)
Gear Type		Spur, External
Bearing Type		Sleeve /Journal
Motor Frame Sizes	NEMA	56C, 143TC, 145TC, 182TC, 184TC
	IEC	71, 80, 90, 100, 112 – B5 Flange
Weight, less motor (approx.)		63 lbs (29 kg)

1 Based on Maximum Speed and zero Differential Pressure.

2 Based on pressure rating of Flanges at ambient temperature.

### PERFORMANCE CURVES

**1 CPS Fluid (Water)**

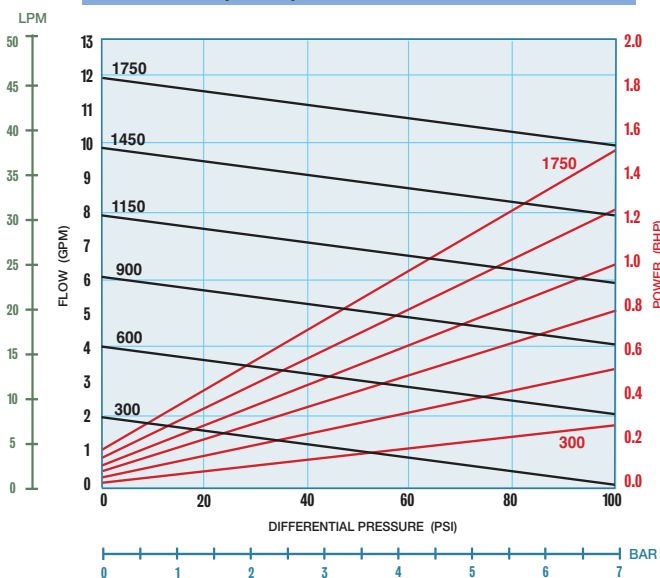

**100 CPS Fluid (Oil)**

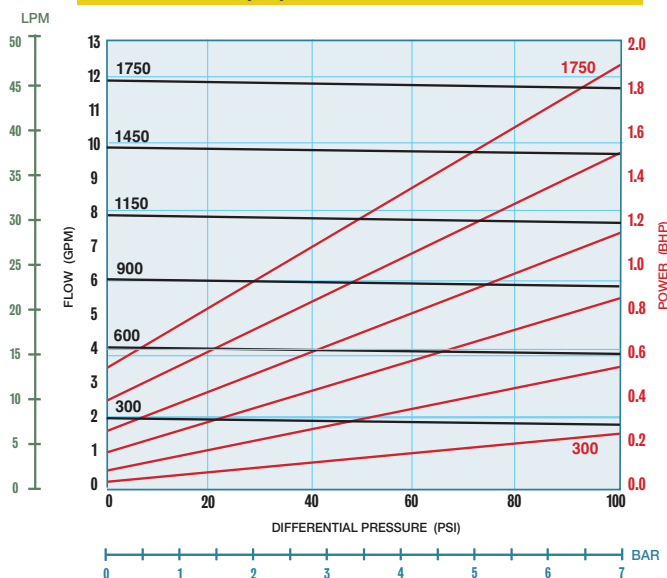

### P6: Mag-Drive, Close-Coupled

Dimensional Data: inches [mm]

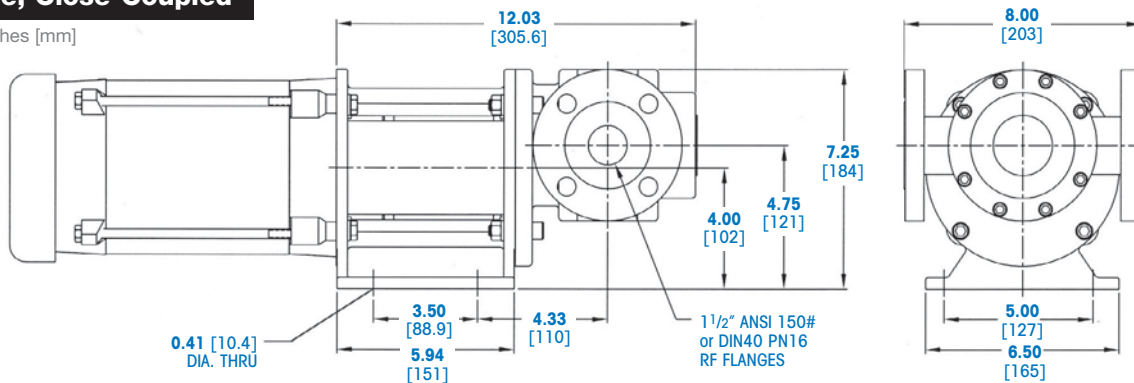

## POLYMER-LINED STAINLESS STEEL GEAR PUMP

MODEL **P7**



**MAG-DRIVE, CLOSE-COUPLED**

Port Size & Type	ANSI	1 1/2" 150# RF Flanges
	DIN	40 mm PN16 RF Flanges
Theoretical Displacement <sup>1</sup>		.00859 gal/rev (.03251 L/rev)
Max Speed		1750 RPM
Max Flow Rate <sup>1</sup>		<b>15.0 GPM (56.9 LPM)</b>
Max Differential Pressure		100 PSI (7 bar)
Max Allowable Pressure <sup>2</sup>		275 PSIG (19 barg)
Max Temperature		200°F (93°C)
NPSHR @ Max Speed		4 ft (1.2 m)
Suction Lift (Dry)		7 ft (2.1 m)
Gear Type		Spur, External
Bearing Type		Sleeve /Journal
Motor Frame Sizes	NEMA	56C, 143TC, 145TC, 182TC, 184TC
	IEC	71, 80, 90, 100, 112 - B5 Flange
Weight, less motor (approx.)		63 lbs (29 kg)

<sup>1</sup> Based on Maximum Speed and zero Differential Pressure.

<sup>2</sup> Based on pressure rating of ANSI 150# Flanges at ambient temperature.

### PERFORMANCE CURVES

**1 CPS Fluid (Water)**

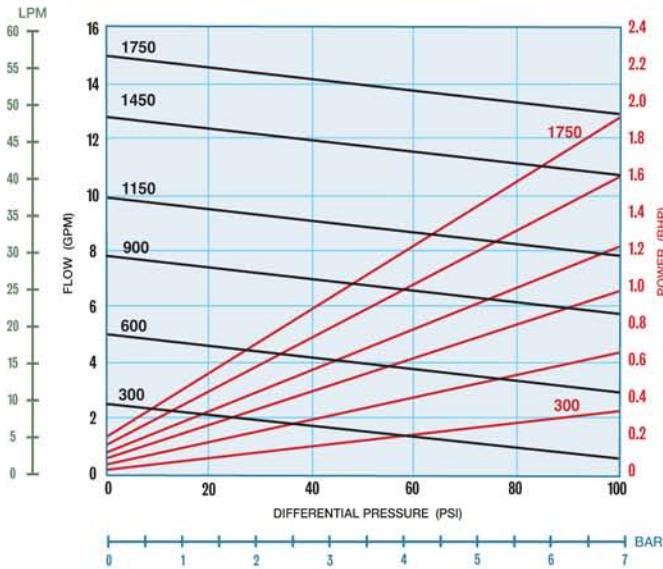

**100 CPS Fluid (Oil)**

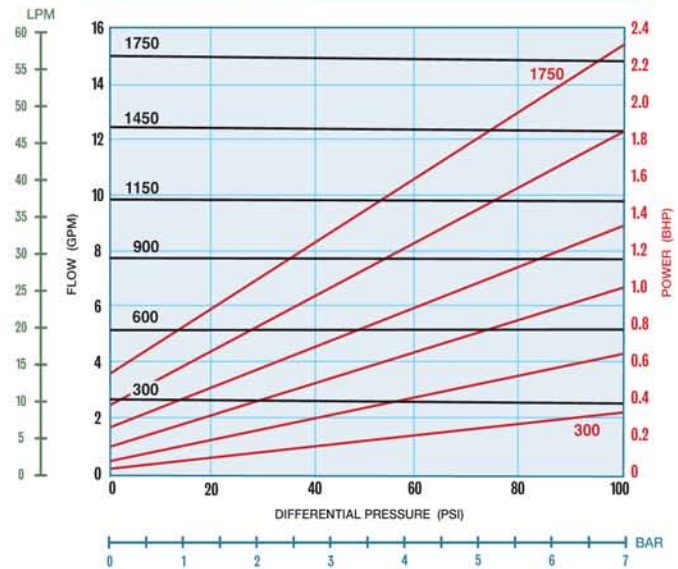

### P7: Mag-Drive, Close-Coupled

Dimensional Data: inches [mm]

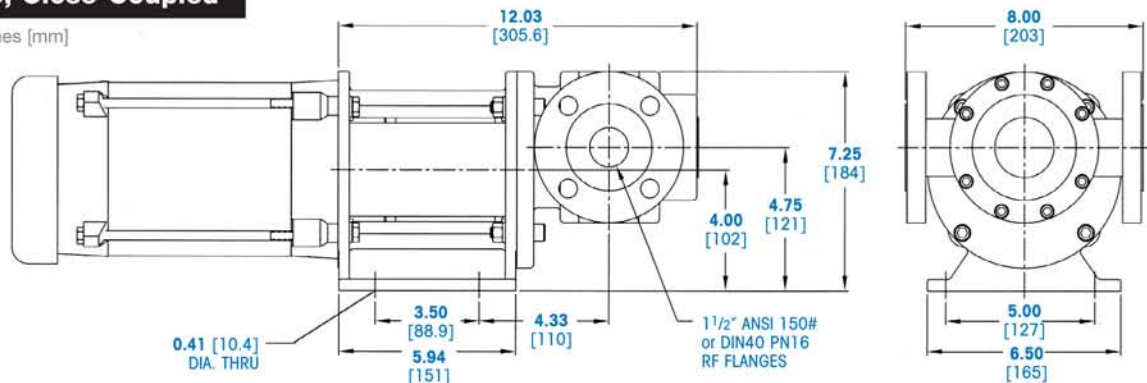

**PUMP MODEL CODING**

**PolyGuard™ SERIES**  
**POLYMER-LINED STAINLESS STEEL GEAR PUMP**

**EXAMPLE:**

**P3LPPBB110BVU**, designates a Model P3 Pump with the following mat'l selection.

<b>P3</b>	<b>L</b>	<b>P</b>	<b>P</b>	<b>B</b>	<b>B</b>	<b>1</b>	<b>1</b>	<b>0</b>	<b>B</b>	<b>V</b>	<b>U</b>
1	2	3	4	5	6	7	8	9	10	11	12

Pos.	Description	Selection
1	Pump Model	P3 P3 Pump
2	Body Mat'l/Ports	L SS/PFA & ANSI Flanges
3	Drive Gear Mat'l	P PEEK
4	Idler Gear Mat'l	P PEEK
5	Wear Plate Mat'l	B Silicon Carbide
6	Bearing Mat'l	B Silicon Carbide
7	Motor Frame Size	1 0.875" (143/145TC)
8	Containment Can	1 SS/PTFE-Lined
9	Bearing Flush	0 None
10	Shafts	B Silicon Carbide
11	O-Rings	V Viton
12	Mag Coupling	U MCU

Liquiflo's Model Code describes both the pump's size and materials selected. This model code is required for the future identification of your pump when reordering either a pump or replacement parts.

- Available
- ⊗ Not Available
- CF Contact Factory

Flanges available: ANSI & DIN

**CONNECTION SIZES**

	P1 - P4	P5 - P7
ANSI 150#	3/4	1 1/2
DIN PN16	20	40

**Selection & Availability**

Sample Model No. **P3 L P P B B 1 1 0 B V U**

Position No. 1 2 3 4 5 6 7 8 9 10 11 12

Position Model		P1	P2	P3	P4	P5	P6	P7
<b>1 Pump Model</b>								
<b>2 Body Material &amp; Port Type</b>	L = SS/PFA Lined & ANSI Flanges E = SS/PFA Lined & DIN Flanges	■	■	■	■	■	■	■
<b>3 Drive Gear</b>	P = PEEK K = Kynar	■	■	■	■	■	■	■
<b>4 Idler Gear</b>	P = PEEK K = Kynar	■	■	■	■	■	■	■
<b>5 Wear Plates</b>	B = Silicon Carbide E = Carbon 60	■	■	■	■	■	■	■
<b>6 Bearings</b>	B = Silicon Carbide E = Carbon 60	■	■	■	■	■	■	■
<b>7 Motor Frame Size</b>	0 = 0.625" (NEMA 56C) 1 = 0.875" (NEMA 143/145TC) 2 = 14 mm (IEC 71 - B5) 3 = 19 mm (IEC 80 - B5) 4 = 24 mm (IEC 90 - B5) 5 = 1.125" (NEMA 182/184TC) 8 = 28 mm (IEC 100/112 - B5)	■	■	■	■	■	■	■
<b>8 Containment Can</b>	1 = SS/PTFE-Lined	■	■	■	■	■	■	■
<b>9 Bearing Flush</b>	0 = Standard Housings (without Bearing Flush)	■	■	■	■	■	■	■
<b>10 Shafts</b>	B = Silicon Carbide	■	■	■	■	■	■	■
<b>11 O-Rings</b>	E = EPDM V = Viton K = Kalrez	■	■	■	■	■	■	■
<b>12 Magnetic Coupling</b>	U = (MCU) 75 in-lbs B = (MCB) 120 in-lbs	■	■	■	■	⊗	⊗	⊗
<b>Suffix Trim Options</b>	- 8 = Temperature Trim - 9D = Viscosity Trim (double clearance) - 9T = Viscosity Trim (triple clearance)	■	■	■	■	■	■	■



Copyright © 2019 Liquiflo  
 All rights reserved. 08-1 PFA

**Represented by:**  
**Zimco Instrumentation Inc.**  
 11141 15 Street NE, Calgary, AB, T3K 0Z5, Canada  
 Phone: 403-253-8320 | Email: info@zimco.ca | Website: www.zimco.ca

Since 1972,  
 Liquiflo pumps have  
 handled thousands  
 of difficult chemicals